

ASSEMBLED MODEL NO.	PLUNGER PART NO.	CAM STYLE	ASSEMBLED ORIENTATION
LI-4132-10-S-0	81400212	STR	0
LI-4132-10-S-60			60
LI-4132-10-S-120			120
LI-4132-10-S-30			30
LI-4132-10-S-90			90
LI-4132-10-S-150	81400222	LH	0
LI-4132-10-L-60			60
LI-4132-10-L-120			120
LI-4132-10-L-30			30
LI-4132-10-L-90			90
LI-4132-10-L-150	81400252	RH	150
LI-4132-10-R-0			0
LI-4132-10-R-60			60
LI-4132-10-R-120			120
LI-4132-10-R-30			30
LI-4132-10-R-90	81400262	RH	90
LI-4132-10-R-150			150

NO	QTY	PART NO	DESCRIPTION	SEAL KIT	CLEVIS PIN KIT
1	3	23050034	RING, RTNG, EXT, 0.312		X
2	2	23340002	STOCK, CORD, .31 X .69, 50, NBR		X
3	3	23350085	SPRING, COMPRESSION	X	
4	3	23650009	BALL, TUNGSTEN-CARBIDE, 4mm	X	
5	4	39051079	O-RING, (6mm X 1)	X	
6	1	39051082	O-RING, (33mm X 2)	X	
7	2	39051087	O-RING, (4mm X 3)	X	
8	1	39053042	SEAL, WIPER, SNAP IN, WED, 18, 94A, AU	X	
9	1	39056002	SEAL, STEP, ROD, 18	X	
10	1	39056022	SEAL, CAP, PISTON, 32, 90A, AU GRPHT FLD	X	
11	2	43068004	PLUG, SOCH, G1/8		
12	1	81400152	CAP, LC/SC, 7MPa, 32B		
13	4	81400200	PLUG, MANIFOLD, 7MPa, M6		
14	3	81400202	PIN, STOP, BALL, METRIC, 4mm BALL	X	
15	1	81400272	PIN, ROCKER, SC, 7MPa, 32B		X
N/A	N/A	L6014320	KIT, SEAL, SC, 7MPa, 32B	NOTED	N/A
N/A	N/A	L6214320	KIT, CLEVIS PIN, SC, 7MPa, 32B	N/A	NOTED



BODY NOT A REPLACEMENT PART

TORQUE TO 10 FT-LB/13.6 Nm

TORQUE DRY JOINT TO 25 IN-LB/2.8 Nm

TORQUE DRY JOINT TO 25 FT-LB/33.9 Nm USING SPANNER TOOL AT150033

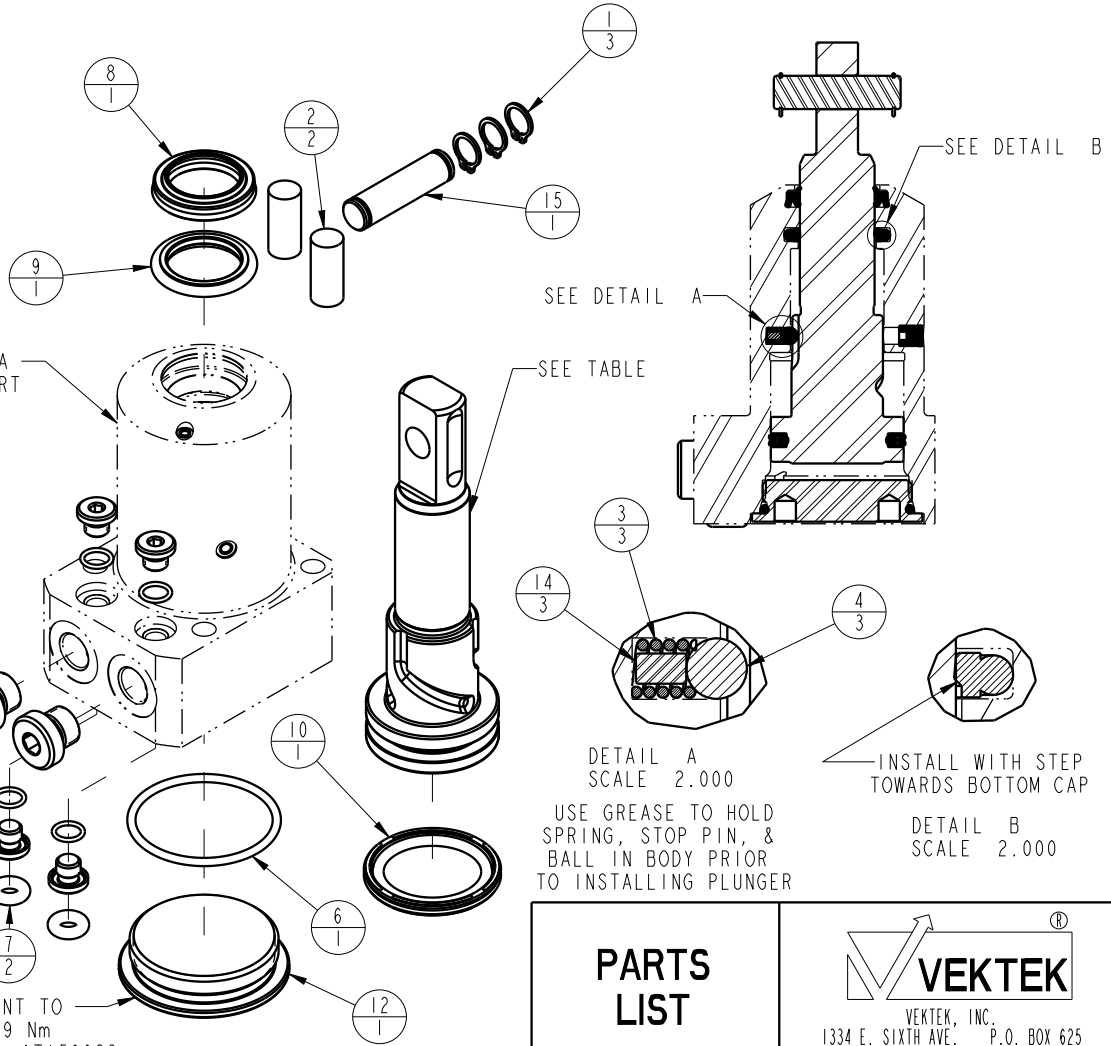

DETAIL A SCALE 2.000
USE GREASE TO HOLD SPRING, STOP PIN, & BALL IN BODY PRIOR TO INSTALLING PLUNGER

DETAIL B SCALE 2.000

PARTS LIST		VEKTEK	
ASSEMBLIES AFFECTED SEE ASSEMBLY MODEL NO. TABLE ABOVE		VEKTEK, INC. 1334 E. SIXTH AVE. P.O. BOX 625 EMPORIA, KS. 66801 U.S.A.	
SIZE A		LPL1431	
REV B		REV B	

B	3273	RELEASE	JDW	08/15/18
REV	IN ACCORDANCE WITH ECN	EFFECTIVE DATE	REVISED BY	DATE
DRW BY: MAJ	DRAWING STATUS: Released			
DATE: 4-16-15	PRODUCTION APPROVED FOR RELEASED STATUS ONLY			